

RETAIL / OFFICE SPACE AVAILABLE For Lease



Summit Point Plaza 200-256 Chipman Road, Lee's Summit, Missouri



Estimated Population
52,570

Average Household Income
\$67,405

Three Mile Radius

- Retail & Office space available: 2,500 sq ft endcap; 1,250 sq ft endcap
- Up to 7,000 sq ft of contiguous space available
- Built-out medical space & ready-to-go day care available
- Affordable lease rates and immediate occupancy
- Chipman Road carries over 14,000 cars per day

BLOCK & COMPANY, INC., Realtors 816.753.6000
In the Skelly Building on the Country Club Plaza
605 West 47th Street, Suite 200, Kansas City, Missouri 64112

For Information Contact:

William Glasgow
816.412.7210
wglasgow@blockandco.com

Bill Maas
816.412.7392
bmaas@blockandco.com

Summit Point Plaza, 200-256 Chipman Road, Lee's Summit, Missouri

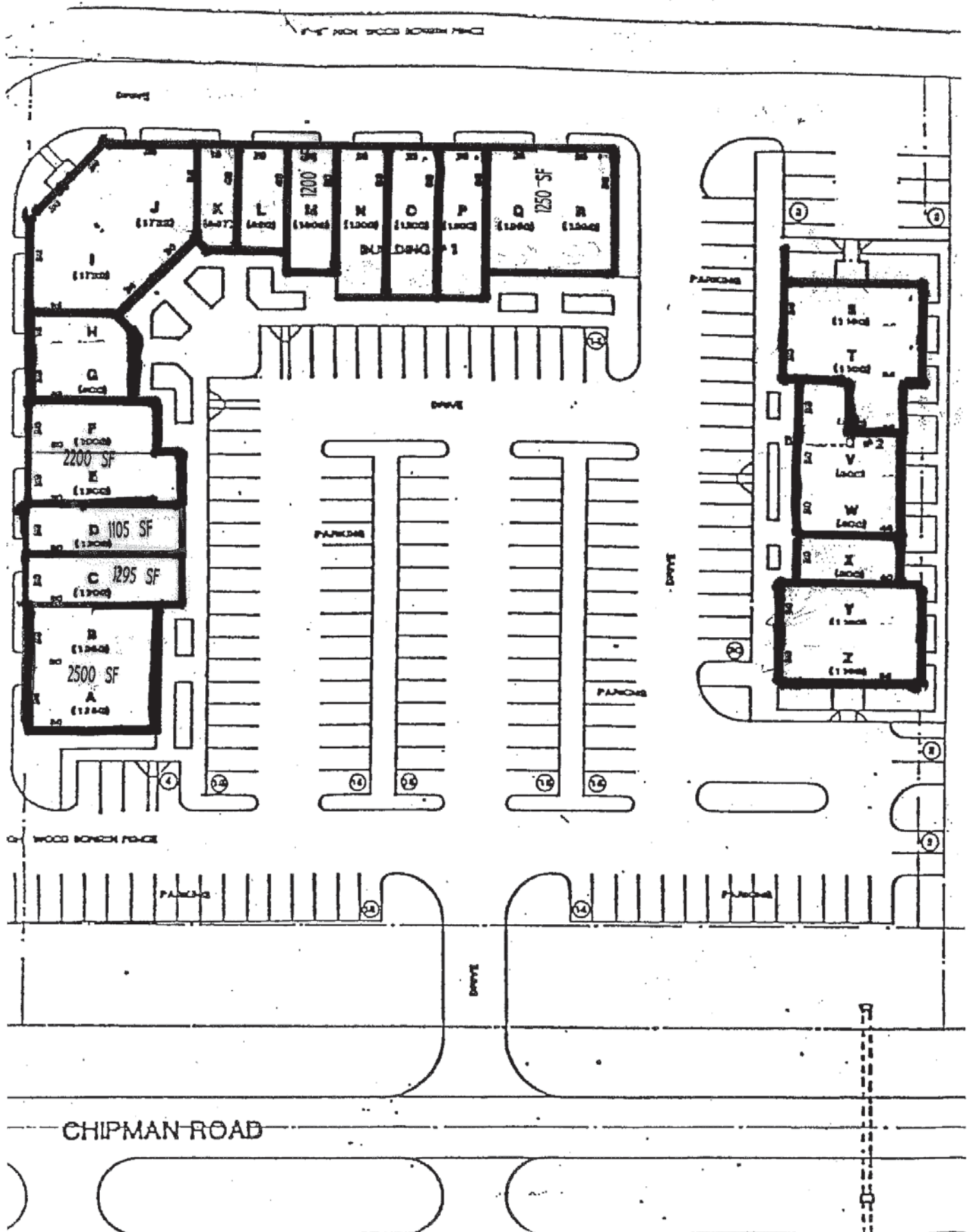



©2010, SITES USA Inc., Chandler, AZ (480) 491-1112. All Rights Reserved.

Chipman Road & Douglas Street Lee's Summit, Missouri

March 2010

This map was produced using data from private and government sources deemed to be reliable. The information herein is provided without representation or warranty.

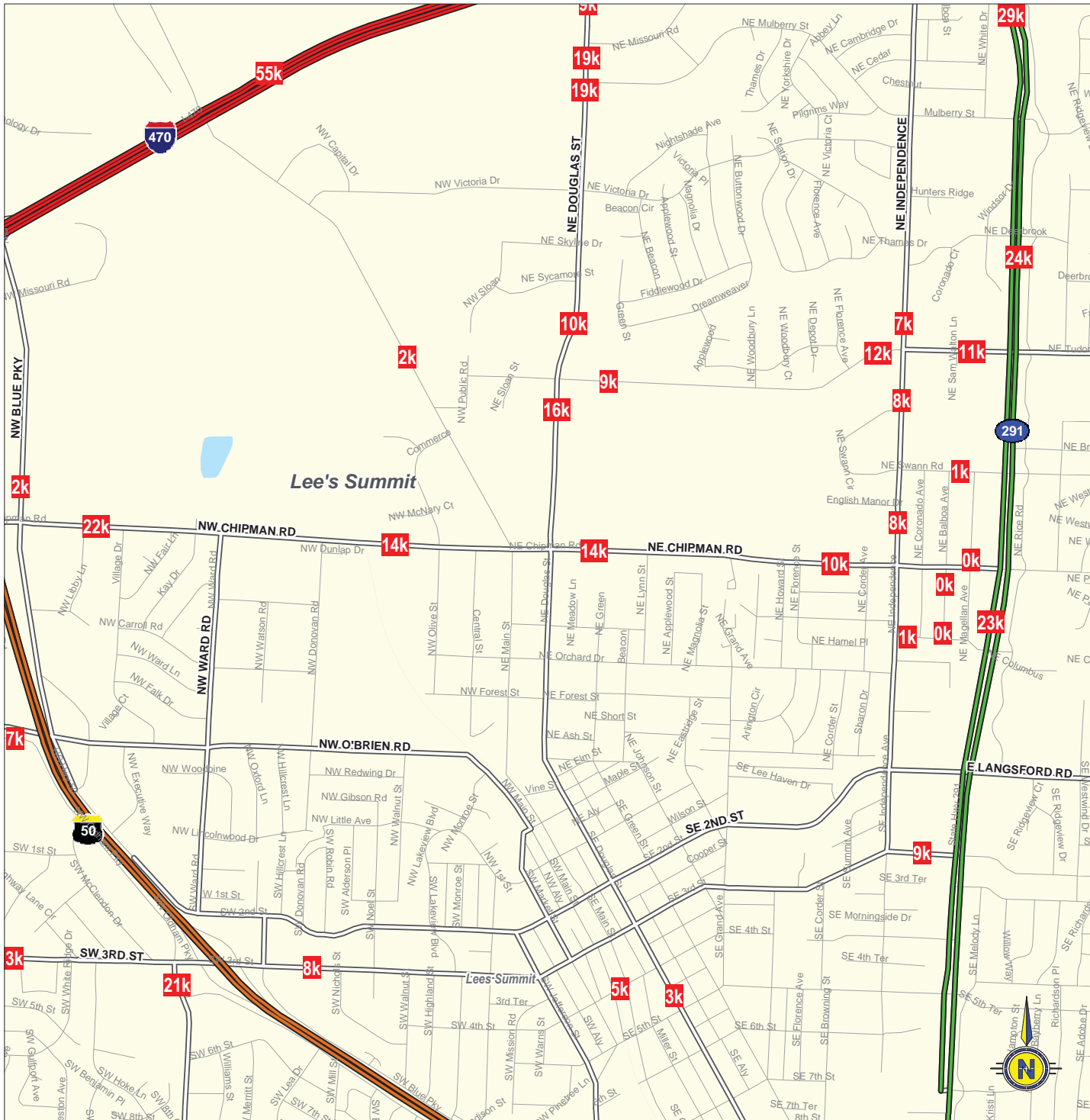

Chipman Road & Douglas Street Lee's Summit, Missouri

Traffic Count Map
(in thousands)

March 2010

This map was produced using data from private and government sources deemed to be reliable. The information herein is provided without representation or warranty.

SUMMARY DEMOGRAPHIC PROFILE

1990 - 2000 Census, 2009 Estimates & 2014 Projections

Calculated using Proportional Block Groups

Lat/Lon: 38.92507/-94.379805

March 2010

RS1

Chipman Road & Douglas Street Lee's Summit, Missouri		1.00 mi radius	3.00 mi radius	5.00 mi radius
POPULATION	2009 Estimated Population	7,303	52,570	83,474
	2014 Projected Population	8,416	55,609	89,361
	2000 Census Population	7,069	48,077	70,581
	1990 Census Population	6,464	36,687	50,721
	Historical Annual Growth 1990 to 2009	0.7%	2.3%	3.4%
	Projected Annual Growth 2009 to 2014	3.0%	1.2%	1.4%
	2009 Median Age	33.5	37.1	37.4
HOUSEHOLDS	2009 Estimated Households	3,177	20,423	31,251
	2014 Projected Households	3,752	21,795	33,640
	2000 Census Households	3,037	18,728	26,681
	1990 Census Households	2,704	14,369	19,344
	Historical Annual Growth 1990 to 2009	0.9%	2.2%	3.2%
	Projected Annual Growth 2009 to 2014	3.6%	1.3%	1.5%
POPULATION BY RACE	2009 Estimated White	91.5%	91.9%	90.7%
	2009 Estimated Black or African American	4.2%	4.5%	5.7%
	2009 Estimated Asian & Pacific Islander	1.0%	1.0%	1.1%
	2009 Estimated American Indian & Native Alaskan	0.5%	0.3%	0.3%
	2009 Estimated Other Races	2.8%	2.3%	2.2%
	2009 Estimated Hispanic	5.7%	5.6%	5.5%
INCOME	2009 Estimated Average Household Income	\$ 51,826	\$ 67,405	\$ 78,602
	2009 Estimated Median Household Income	\$ 53,715	\$ 71,071	\$ 80,283
	2009 Estimated Per Capita Income	\$ 22,545	\$ 26,390	\$ 29,653
EDUCATION (AGE 25+)	2009 Elementary	2.0%	1.4%	1.2%
	2009 Some High School	6.2%	4.6%	4.2%
	2009 High School Graduate	29.8%	24.6%	23.8%
	2009 Some College	25.4%	24.8%	23.7%
	2009 Associates Degree Only	8.8%	8.6%	8.4%
	2009 Bachelors Degree Only	19.2%	23.8%	24.6%
	2009 Graduate Degree	8.6%	12.2%	14.1%
BUSINESS	Number of Businesses	643	2,301	2,994
	Total Number of Employees	7,100	30,442	38,184
	Employee Population per Business	11.0	13.2	12.8
	Residential Population per Business	11.4	22.8	27.9

This report was produced using data from private and government sources deemed to be reliable. The information herein is provided without representation or warranty.